

SD-800/WCT-APR

HOIST CONTROLLER



HOIST CONTROLLER

SD-800/WCT-APR

DIRECT CONTROL TWIST-LOCK

The SD-800/WCT-APR is an 8x channel Hoist Controller for Direct Control chain hoists. It features 8 TL-4-20A connectors that make efficient cable management possible. This controller also has one hot-pocket for pickle hook-up.

The SD-800-WCT-APR comes with automatic phase reverse (APR) as a standard feature. When the main supply is connected, there is no need to worry about switching over to the proper lifting direction. This controller can be used with a SD-100 as a main power distribution capable of driving up to six units.

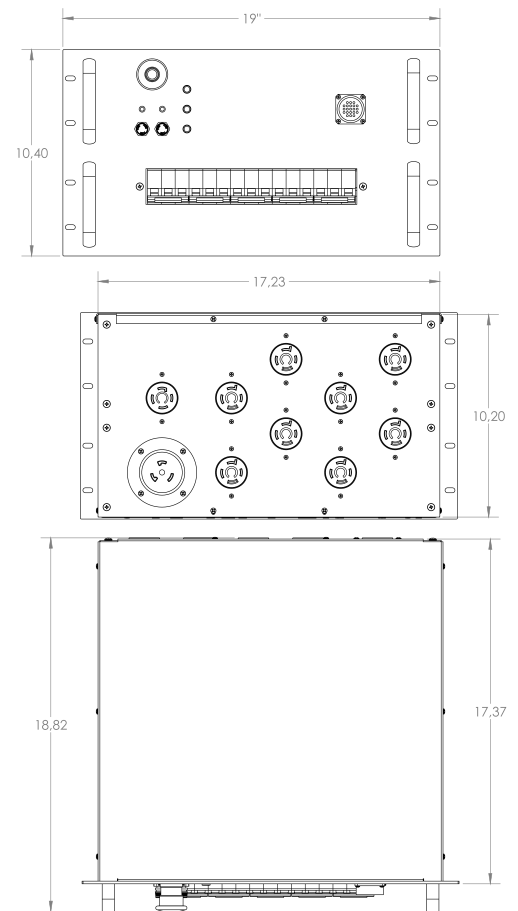

DIMENSIONS ARE IN INCHES

The Standard configuration comes with:

FEATURES

On Front Panel:

- Integrated E-Stop Button
- Circuit Breaker: 4 for Chain Hoist, 1 for Hot Pocket
- Pendant Input Connector, Tajimi 21-Pin (Veam 25-Pin as an Option)

On Back Panel:

- Power Input Connector, 120/208V 3Ph, TL4-50A - CS8375
- Power Output Connector, 8x TL4-20A - HBL-2420
- Hot Pocket Connector for Direct Pickle, TL4-30A - HBL-2720
- Automatic Phase Reverse as a Standard Feature (APR)
- 6RU Rack Mount Enclosure
- **Weight:** 45 Lbs

Certified

